

	A1	A2	B	C	D	E	F	G	H	J	K	L	M	N	P	Q
DELSA03 / 0	78	95	75	20	19	2	2	7		13	8	24		5.5	8	34.5
DELSA04 / 1	103	120	100	23	21	2	2	9		15	9.5	28		5.5	8	37.5
DELSA05 / 5	128	147	125	28	22.5	2.4	2	9		20	9.5	36	63	5.5	8	44.5
DELSA06 / 9	153	171	150	30	25	3	2.5	9	14	20	9	37	75	5.5	9	48.25
DELSA07 / 13	179	203	175	38	29	3.6	3.5	10	17	25	15	50	88	7	12	57.5
DELSA08 / 17	203	228	200	42	33	4	4	10	18	30	16	57	100	7	12	34

Other finishes (*RAL colours etc...*) are available to order - (a surcharge may apply).
 The spring mechanism and tension retaining pins are manufactured from stainless steel.
 Reverse springing (hold open) models are available to order.

Characteristics common to all the Liobex hinge models

	Model No.	LSA03	LSA04	LSA05	LSA06	LSA07	LSA08
Height of Leaf	mm	75	100	125	150	175	200
	inch	3	4	5	6	7	8
To suit max door thickness	mm	20 - 25	21 - 30	25 - 35	25 - 40	33 - 50	35 - 55
To suit max door width	mm	650	700	780	850	920	1000

Characteristics specific to the Liobex Compact range

Weight of the hinge - pair	Kg	0.390	0.580	0.850	1.290	1.765	2.530
Max torque at 90° - per hinge	daN	0.250	0.350	0.500	0.700	0.850	1.200
Max weight of door - per pair	Kg	10	15	25	35	45	55
Fixing screws recommended - Countersunk Screw		4 x 20	4 x 20	4 x 25	4.5 x 25	6 x 30	6 x 30

Characteristics specific to Liob range - with end caps

Max weight of door - per pair	Kg	0.625	0.870	1.390	1.970	2.675	3.840
Max torque at 90° - per hinge	daN	0.400	0.500	0.600	0.950	1.000	1.400
Max weight of door - per pair	Kg	12	20	30	40	50	70
Fixing screws recommended - Countersunk Screw		4 x 20	4 x 25	4.5 x 25	5 x 25	6 x 30	6 x 30

CI/SfB	31/59	Xt 7
January 2004		

Installation of Liobex single action spring hinges

To install Liobex Single Action Spring Hinges it may be necessary to fix a plant down the hanging frame. The width of the plant should be sufficient to provide a bearing surface for the flanged face (C) of the hinge. The thickness of the plant should be sufficient to allow the hinge cylinder to rotate freely after the leaf has been morticed into the door, ensuring that the cylinder is free to rotate and that standard door / plant clearance is maintained.

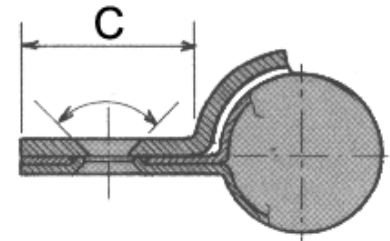

Liobex Single Action Hinges up to 6" are supplied in right hand configuration only, the capstan being at the top of the hinge. For left hand doors the capstan is set at the bottom. 7" and 8" are supplied handed and should be fitted accordingly with the capstan at the top in both instances.

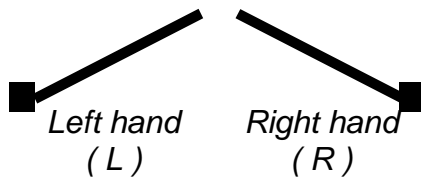

Normal installation should be 250mm from the top and bottom of the door. In the event of a door being oversize, a third hinge may be fitted 100mm below the top hinge. Care must be taken that the centre line of the hinges is in alignment.

Adjustment

Normal operation of the hinge is achieved by tightening the capstan on each hinge and inserting the pin provided. Normally the top hinge(s) will not require more than three (3) holes, and the bottom Hinge two (2) holes.

DO NOT OVERTIGHTEN THE CAPSTANS

Maintenance

Liobex Spring Hinges are lubricated before despatch. We recommend annual lubrication to maintain trouble free operation.

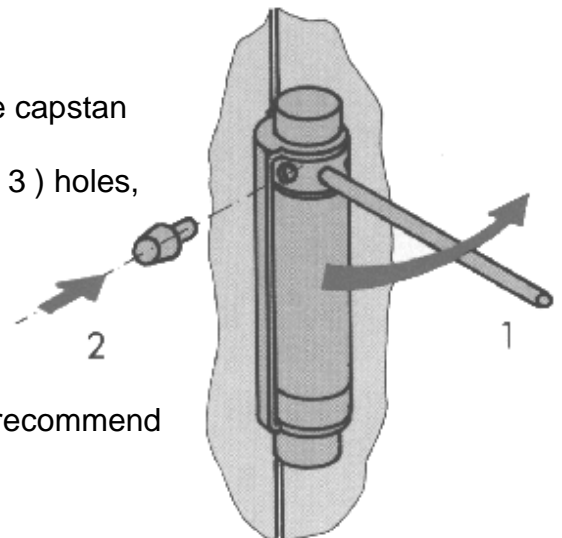

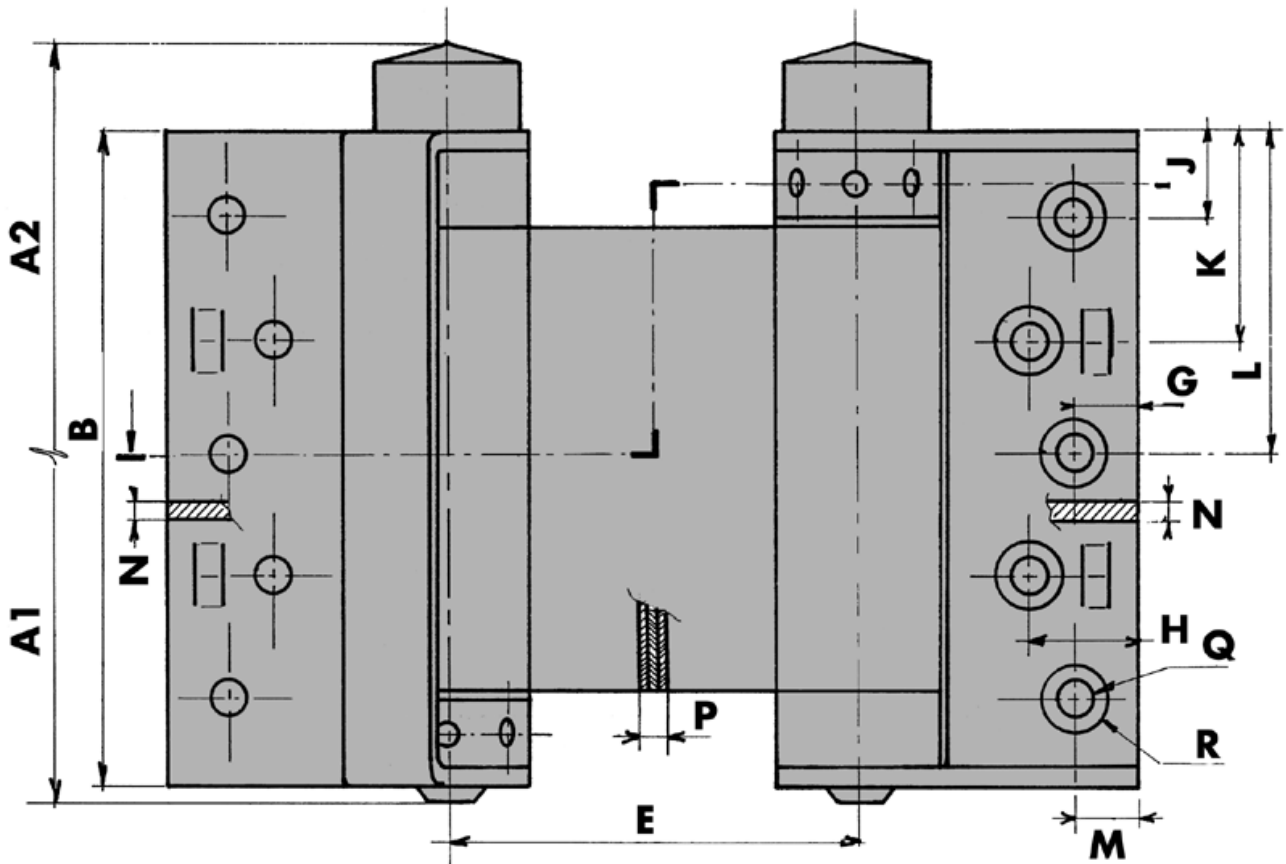

G : EXCEPT HINGES - LDA03 & LDA04

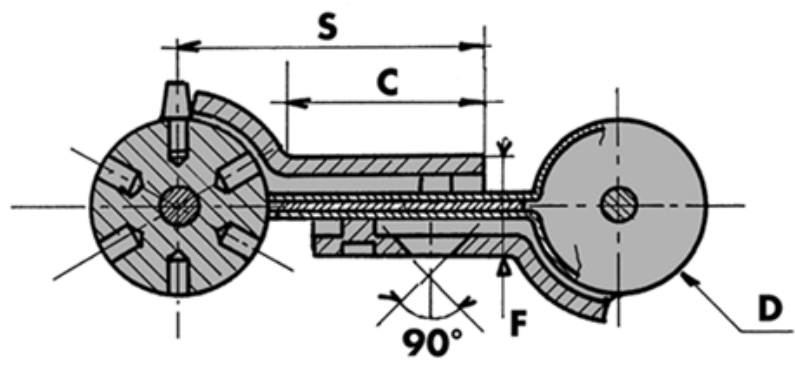

	A1	A2	B	C	D	E	F	G	H	J	K	L	M	N	P	Q	R	S
DELDA03 / 29	78	95	75	20	19	47	11	7.5	12.5	10	24			2	3	5.5	8	33
DELDA04 / 30	103	120	100	25	21	54	11	8	16	11	27			2	3	5.5	8	40
DELDA05 / 33	128	147	125	30	22.5	62.5	12.5	11	21	12	35	62.5		2	3.9	5.5	8	45
DELDA06 / 36	153	172	150	35	25	70	14.5	17	22	14	37	75	10	2.5	4.5	5.5	8	52
DELDA07 / 39	179	203	175	40	29	78	16.5	18.5	29	15	42.5	87.5	11	3	5.4	7	11	59
DELDA08 / 42	203	228	198	45	32	85	17	23.5	34	14	43	99	11	3	6	7.2	11	65.5

Characteristics common to all the Liobex hinge models							
	Model No.	LDA03	LDA04	LDA05	LDA06	LDA07	LDA08
Height of Leaf	mm	75	100	125	150	175	200
	inch	3	4	5	6	7	8
To suit max door thickness	mm	20 - 25	21 - 30	25 - 35	25 - 40	33 - 50	35 - 55
To suit max door width	mm	650	700	780	850	920	1000
Characteristics specific to the Liobex Compact range							
Weight of the hinge - pair	Kg	0.75	1.120	1.620	2.510	3.670	4.850
Max torque at 90° - per hinge	daN	0.250	0.350	0.500	0.700	0.850	1.200
Max weight of door - per pair	Kg	10	15	25	35	45	55
Fixing screws recommended - Countersunk Screw		4 x 20	4 x 20	4 x 25	4.5 x 25	6 x 30	6 x 30
Characteristics specific to Liob range - with end caps							
Max weight of door - per pair	Kg	1.070	1.680	2.400	3.310	4.850	6.370
Max torque at 90° - per hinge	daN	0.400	0.500	0.600	0.950	1.000	1.400
Max weight of door - per pair	Kg	12	20	30	40	50	70
Fixing screws recommended - Countersunk Screw		4 x 20	4 x 25	4.5 x 25	5 x 25	6 x 30	6 x 30

CI/SfB	31/59	Xt 7	
January 2004			

Installation of Liobex double action spring hinges

To install Liobex double action spring hinges correctly it is necessary to have or fix a plant down the hanging frame. Ideally the width of the plant should be the same dimension as the thickness of the door. The thickness of the plant should be sufficient to allow the hinge cylinders to rotate freely after the lipped face (C) has been morticed in. The other lipped face should be morticed into the door, ensuring that both cylinders are free to rotate and that standard door plant clearance is maintained.

The capstan should be fitted at the top on the plant, and at the bottom on the door. This configuration will ensure optimum efficiency and minimum wear.

Normal installation should be 250mm from the top and bottom of the door. In the event of a door being oversize, a third hinge may be fitted 100mm below the top hinge. Care must be taken to ensure that the centre line of the hinges is in alignment.

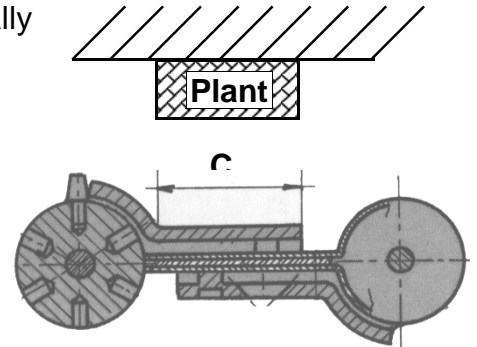

Adjustment

Normal operation of the hinge is achieved by tightening both capstans on each hinge and inserting the pins provided. Normally the top hinge (s) will not require more than three holes, and the bottom hinge two holes.

DO NOT OVERTIGHTEN THE CAPSTANS

Maintenance

Liobex Spring Hinges are lubricated before despatch. We recommend annual lubrication to maintain trouble free operation.

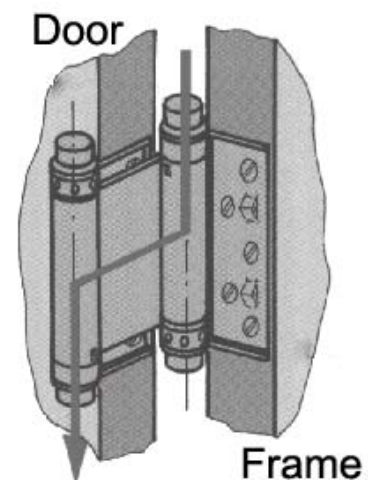

© D&E Architectural Hardware Ltd 2003